

# User manual

## MTinfo 3000 web



**ti DualInventive**  
Ubiquitous Rail

---

**DUAL INVENTIVE | BELGIËSTRAAT 5 | 5061 KG OISTERWIJK**

Telephone: +31 (0)13-5339969

Email: [info@dualinventive.com](mailto:info@dualinventive.com)

Internet: [dualinventive.com](http://dualinventive.com)

Date: August 2022

Version: 0.6

User manual: original language English

---

## TABLE OF CONTENTS

<b>1</b>	<b>Remote Switching .....</b>	<b>3</b>
1.1	Mobile app – Single zone switching.....	4
1.2	Mobile app – Multiple zone switching .....	10
1.3	Web application – Single zone switching .....	16
1.4	Web application – Multiple zone switching .....	22

## 1 REMOTE SWITCHING

MTinfo 3000 allows a user to switch devices remotely via a mobile application or a web browser.

By default, a company can switch only one protection zone at a time but it is possible to enable switching of multiple protection zones at once for one or more specific companies.

This setting can only be changed by the MTinfo 3000 administrator of your company. When this setting is switched 'on', users must refresh their screen in order to see the change activated.

It is not possible to switch 'off' this setting when released projects are present for the particular company.



### NOTE

This manual describes the switching of one or multiple protection zones. The creation or administration of protection zones is not impacted due to this functionality.

## 1.1 Mobile app – Single zone switching

1. On the start page, tap the 'RS' tile and then tap the project for which you want to switch a zone.

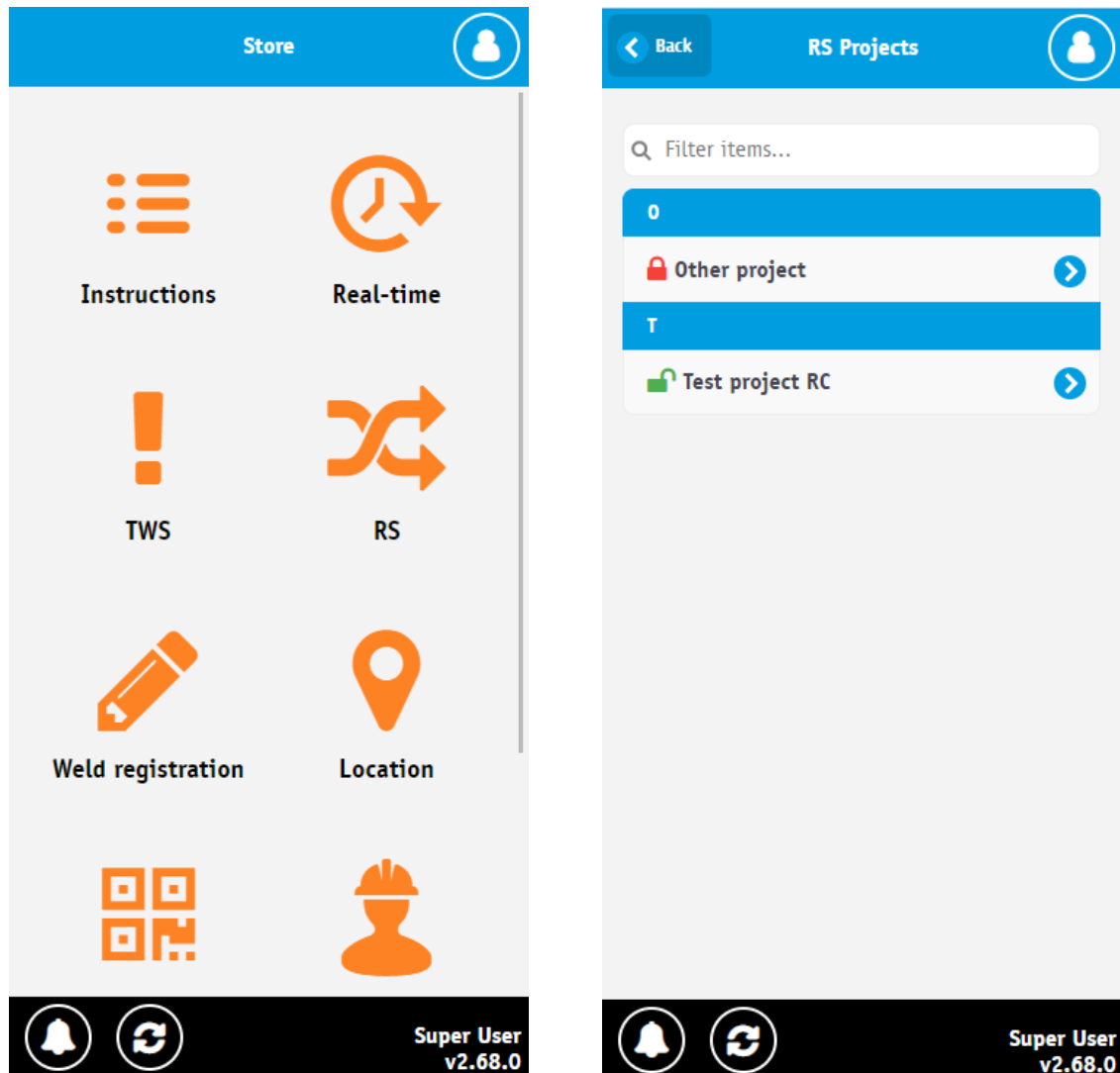

- a. You can only switch protection zones for a released project which are marked with a green open lock icon. Unreleased projects have a red closed lock icon.

2. Tap the protection zone you want to switch. Tap the "+" icon to show the devices assigned to the protection zone.

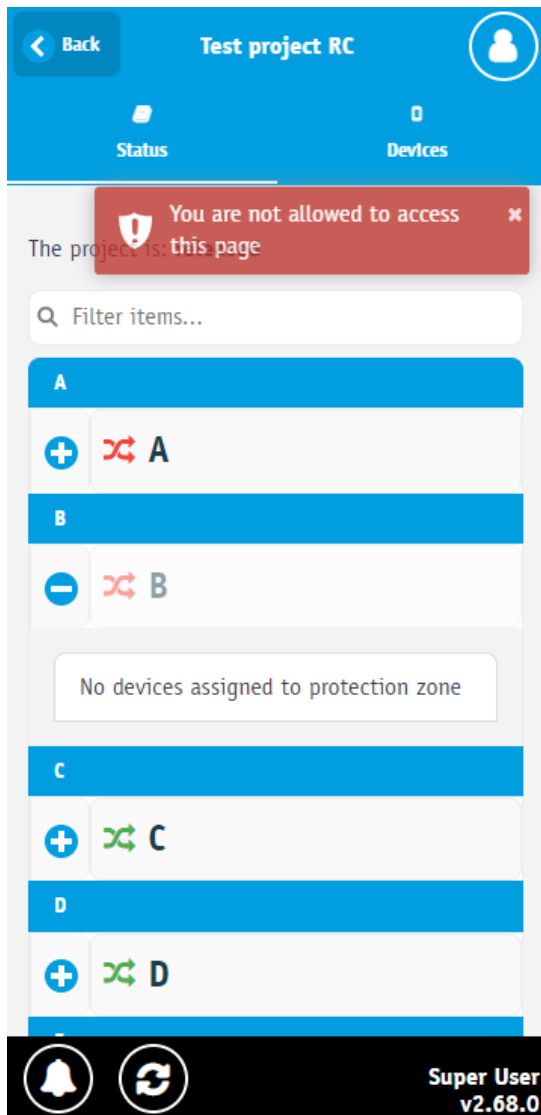

- a. If a protection zone has no devices, the zone is disabled and the message "No devices assigned to protection zone" is shown.
- b. If you are not an operator assigned to the protection zone you will see the error "You are not allowed to access the page" when you click on the projection zone.
- c. Device data is updated in real time.

3. Tap "on" or "off" to respectively switch the devices in the protection zone on or off.

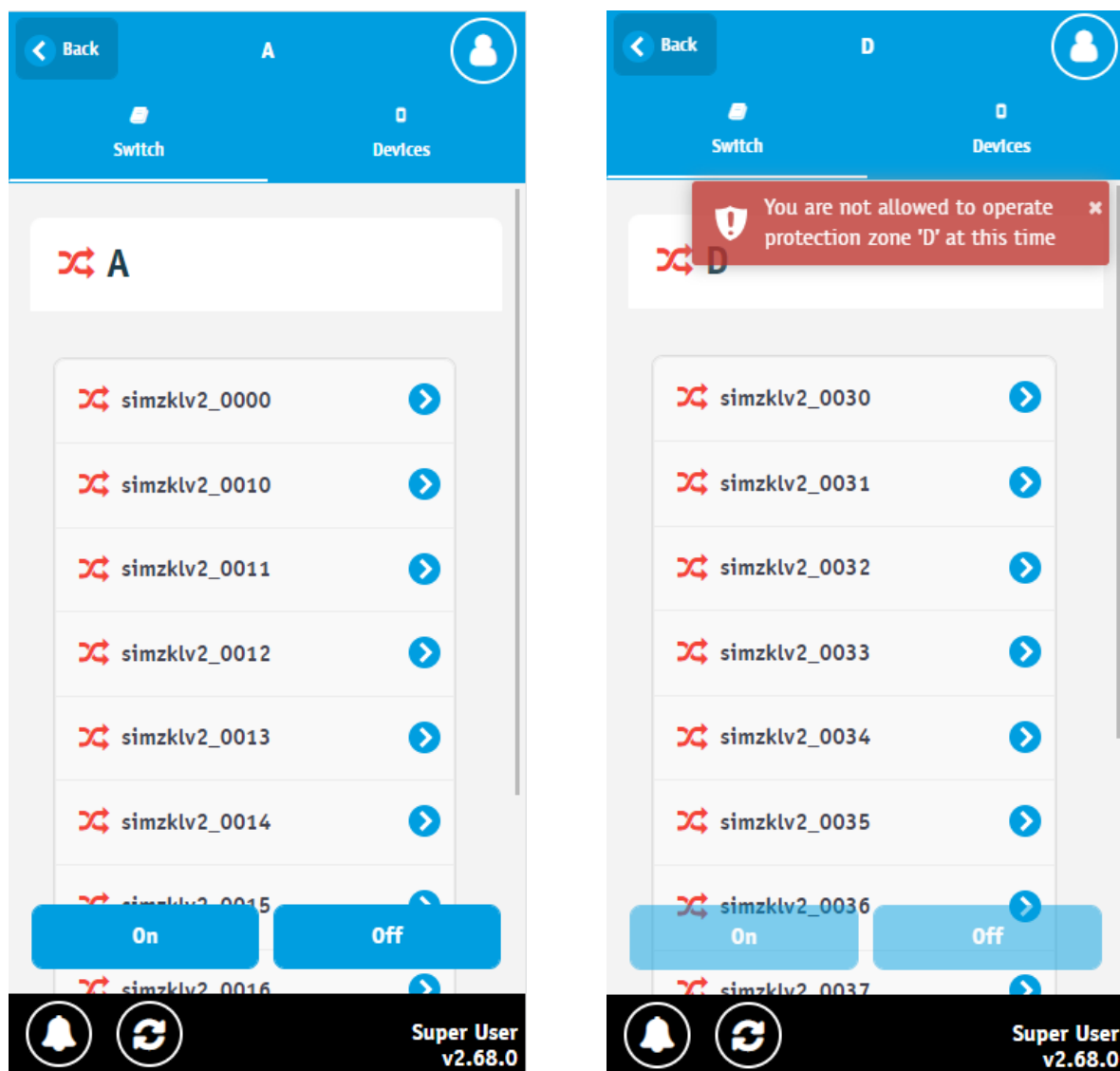

- a. The protection zone icon is colored green if all devices within the zone are successfully activated, red if not all devices are currently activated or if a device is reporting problems. If the status is unknown, it will be colored light grey.
- b. The latest status of all devices in the protection zone is indicated by an icon .
  - i. Light grey indicates the status is unknown.
  - ii. Green indicates the device is currently successfully activated and no problems are reported.
  - iii. Red in all other cases.
- c. If you are not allowed to operate the protection zone at the current time, the on/off buttons will be disabled and the error "You are not allowed to operate zone 'X' at this time" will be shown. Refresh the page to recheck using the refresh button at the bottom of the screen.
- d. Device data is updated in real time.

4. Tap the proper letters to spell "on" or "off" depending on the action you chose, enter your pin code and tap "Switch" to continue or "Cancel" to abort.

< Back Switch on 

You are about to switch devices in

A

Type 'ON' to continue

O N

N O S C B

Q



Enter your pin code

....

Switch

Cancel

 Super User v2.68.0

5. A loading screen is shown while the request is being processed. When the request is processed, the result is shown.

When the request is successful the result will be similar to the example below:

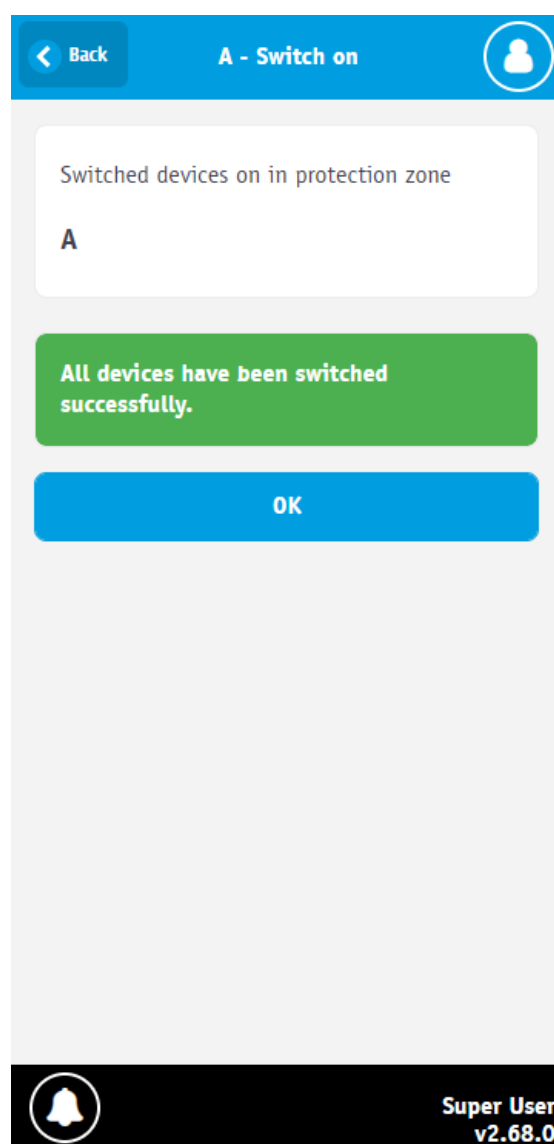
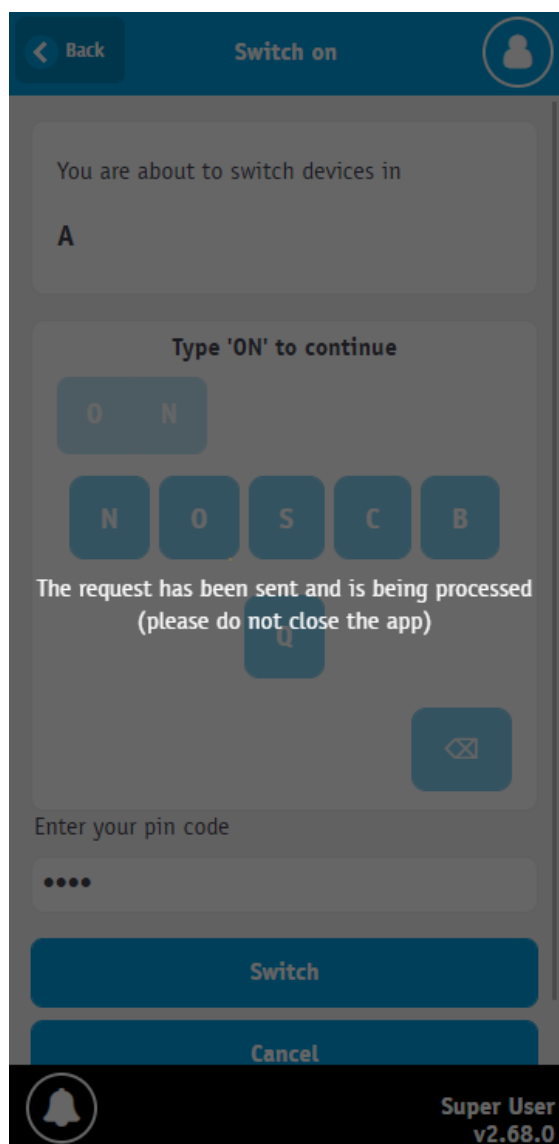



In case there are errors and/or warnings, the result will be similar to the example below:

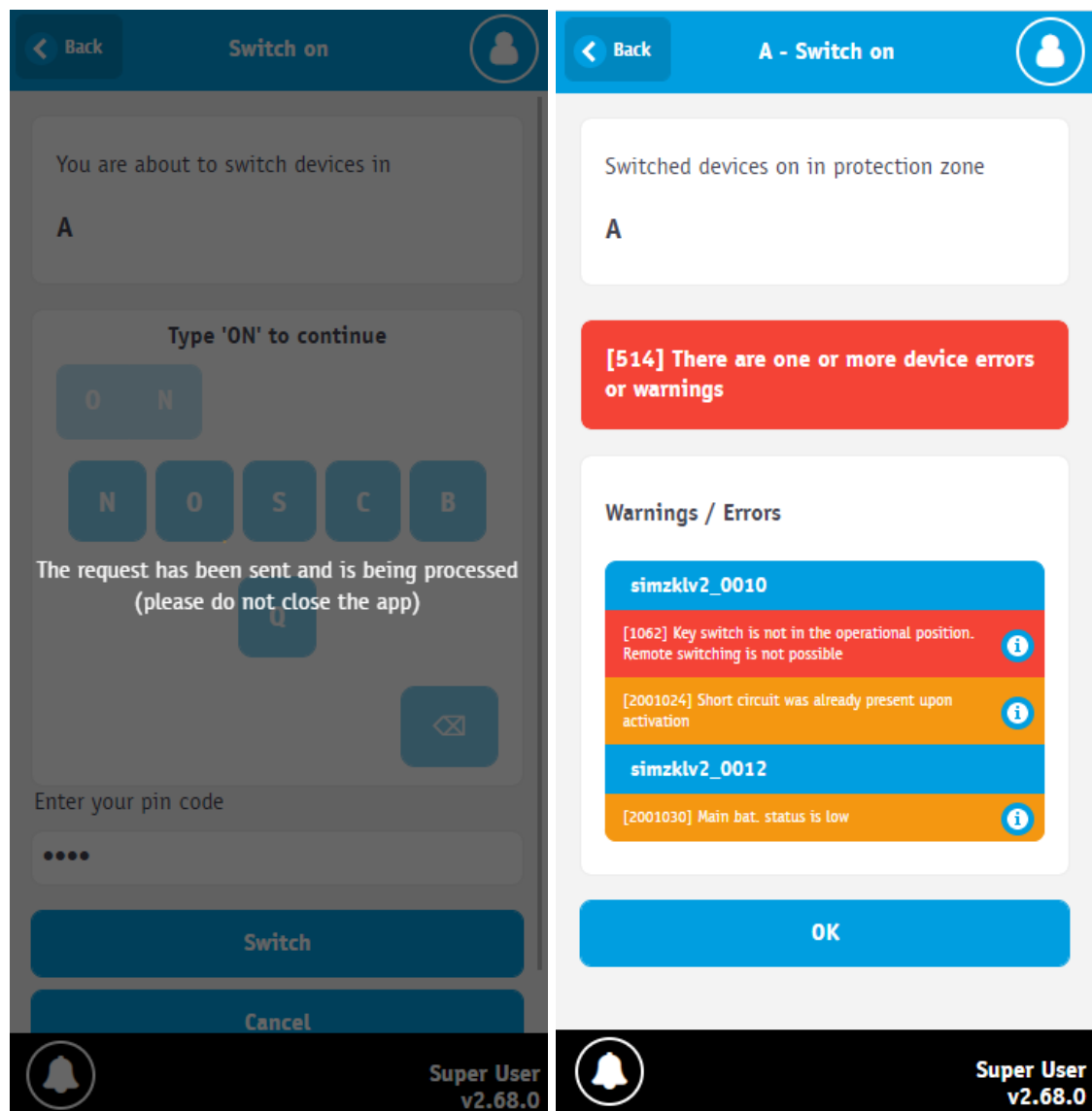

- a. Errors and warnings are grouped per device.
  - b. Follow the instruction provided in the error/warning to resolve the issue, if this does not solve the problem contact Dual Inventive Support.
6. Tap "OK" to return to the "Switch zone" page.

## 1.2 Mobile app – Multiple zone switching



### NOTE

It is only possible to switch multiple zones at once if this setting is enabled for your company.

This setting can only be changed by the MTinfo 3000 administrator of your company.

On the start page, tap the 'RS' tile and then tap the project for which you want to switch a zone.

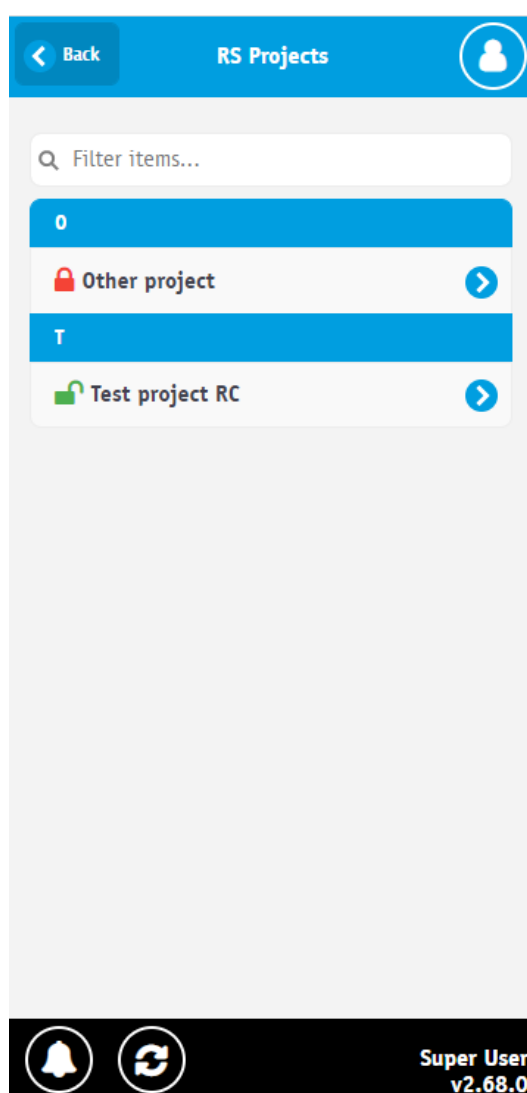
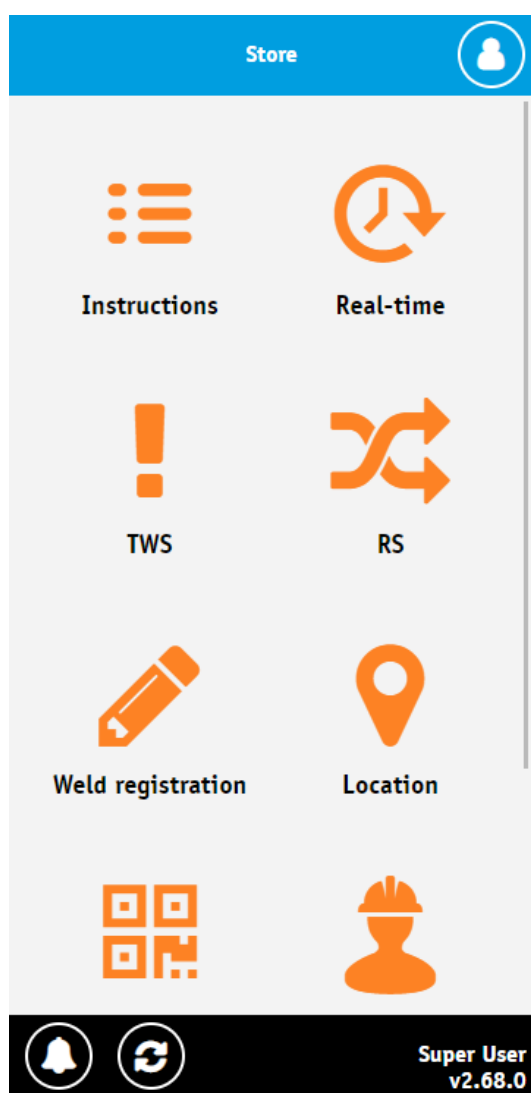

- a. You can only switch protection zones for a released project which are marked with a green open lock icon. Unreleased projects have a red closed lock icon.

2. Tap one or more protection zones you want to switch or use the "select all" button to check/uncheck all protection zones. Then tap "Switch" to continue.

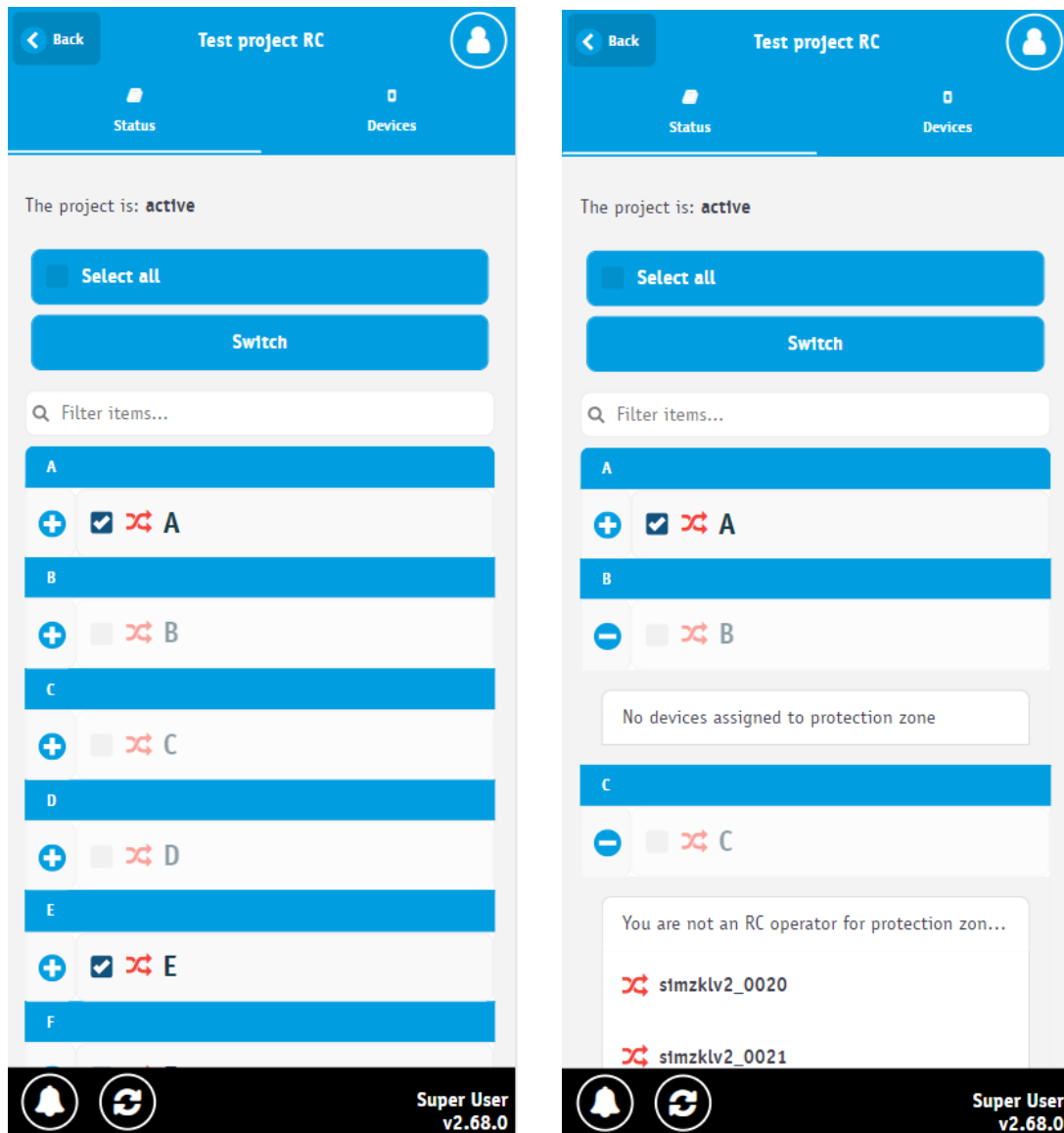

- a. If a protection zone has no devices, the zone is disabled and the message "No devices assigned to protection zone" is shown.
- b. If you are not an operator assigned to the protection zone, the zone is disabled and you will see the message "You are not an operator for protection zone 'X'".
- c. If you are not allowed to switch at the current time, the zone is disabled and you will see the message "You are not allowed to operate protection zone 'X' at this time.".
- d. Device data is updated in real time.

3. Tap "on" or "off" to respectively switch the devices in the selected protection zones on or off. Tap the "+" icon to show the devices assigned to the protection zone.

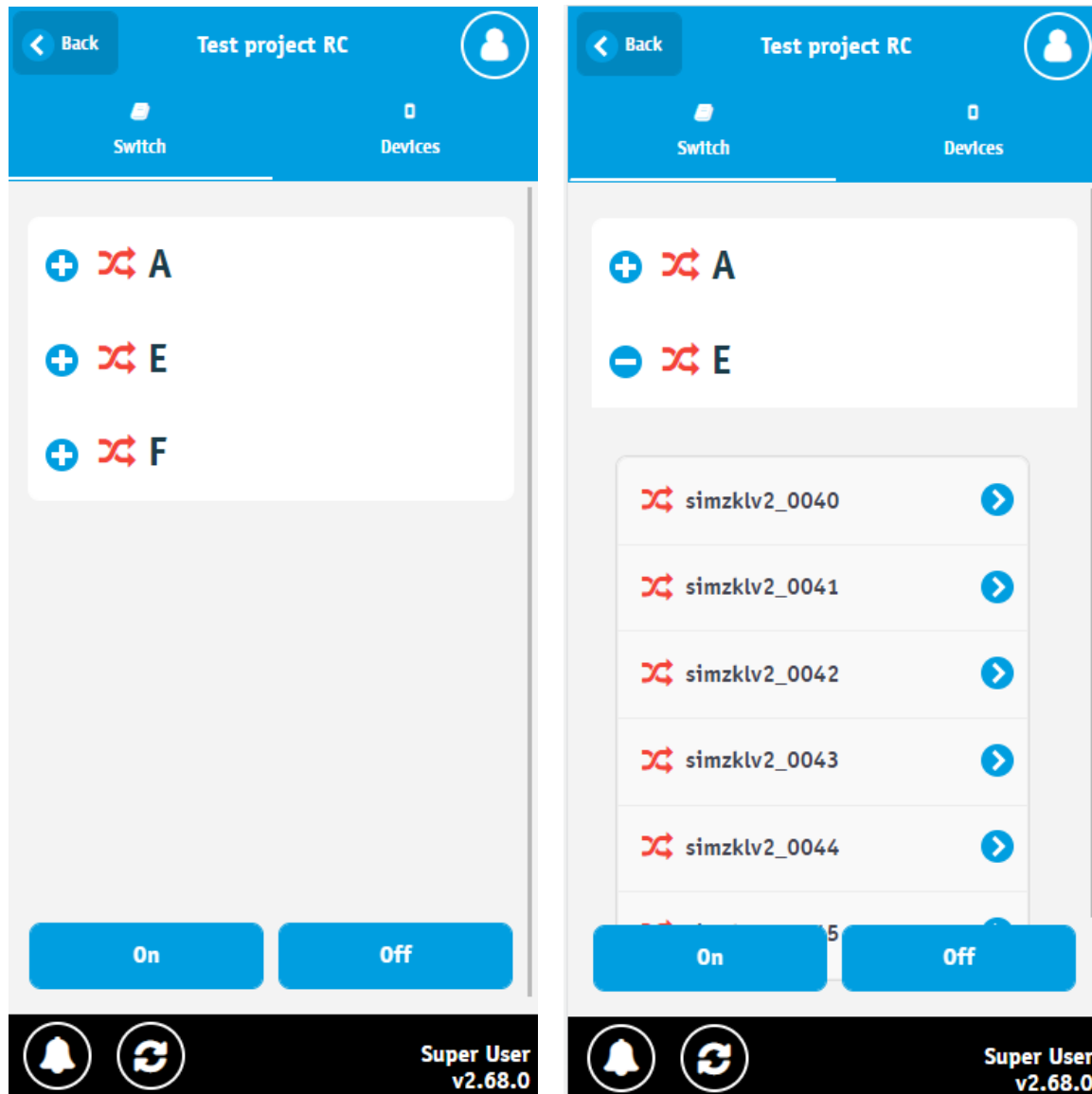

- a. The protection zone icon is colored green if all devices within the protection zone are currently successfully activated,
  - i. red if not all devices are currently activated or if a device is reporting problems.
  - ii. If the status is unknown, it will be colored light grey.
- b. The latest status of all devices within the protection zone is indicated by an icon .
  - i. Light grey indicates the status is unknown.
  - ii. Green indicates if the device is currently successfully activated and no problems are reported.
  - iii. Red in all other cases.
- c. You can click the devices for more details.
- d. Device data is updated in real time.

4. Tap the proper letters to spell "on" or "off" depending on the action you chose, enter your pin code and tap "Switch" to continue or "Cancel" to abort.

Switch on

You are about to switch devices in

A  
E  
F

Type 'ON' to continue

O N

G B N O S

C

Enter your pin code

Switch

Cancel

Super User  
v2.68.0

5. A loading screen is shown while the request is being processed. When the request is processed, the result is shown.

When the request is successful the result will be similar to the example below:

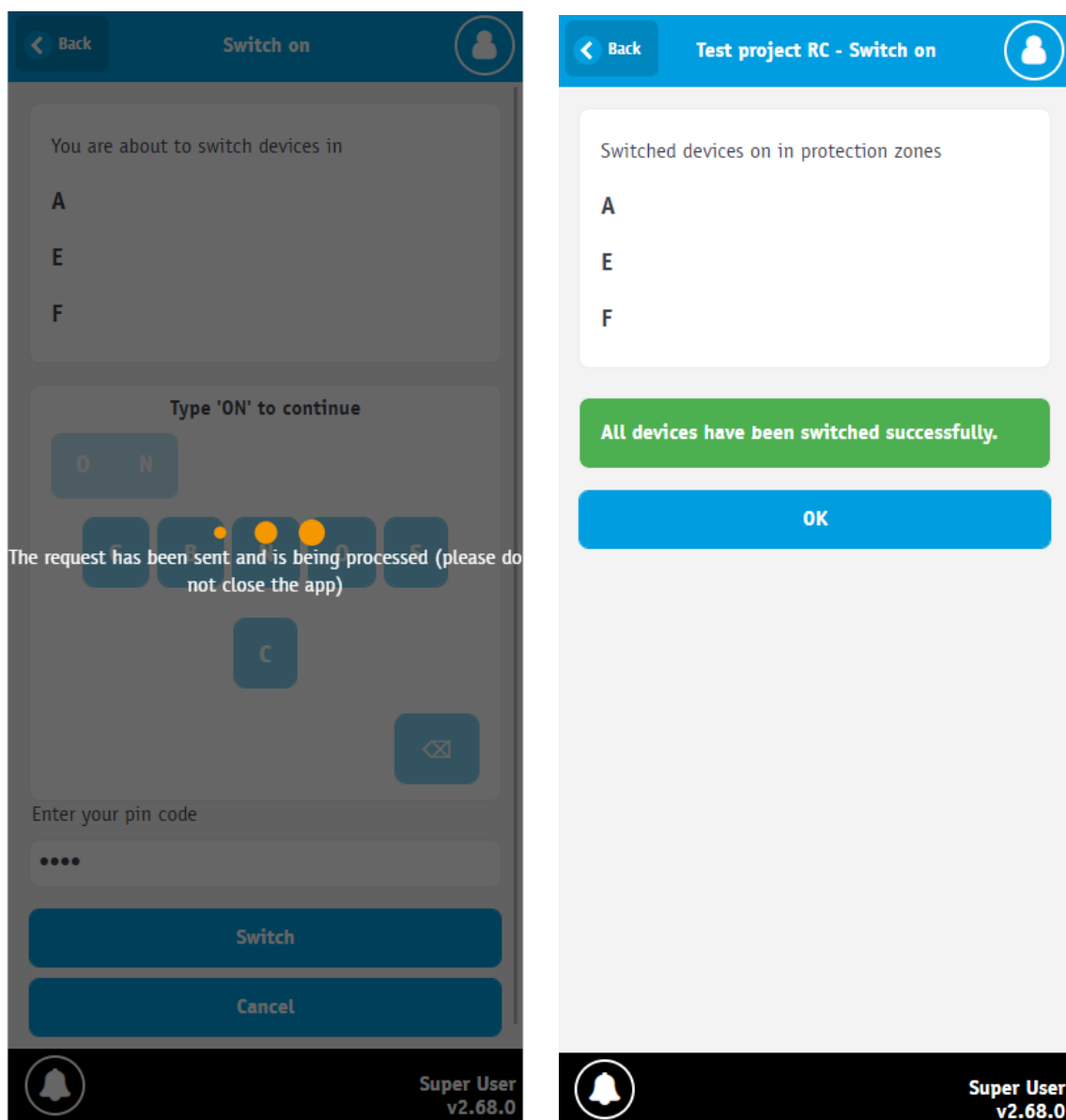

In case there are errors and/or warnings, the result will be similar to the example below:

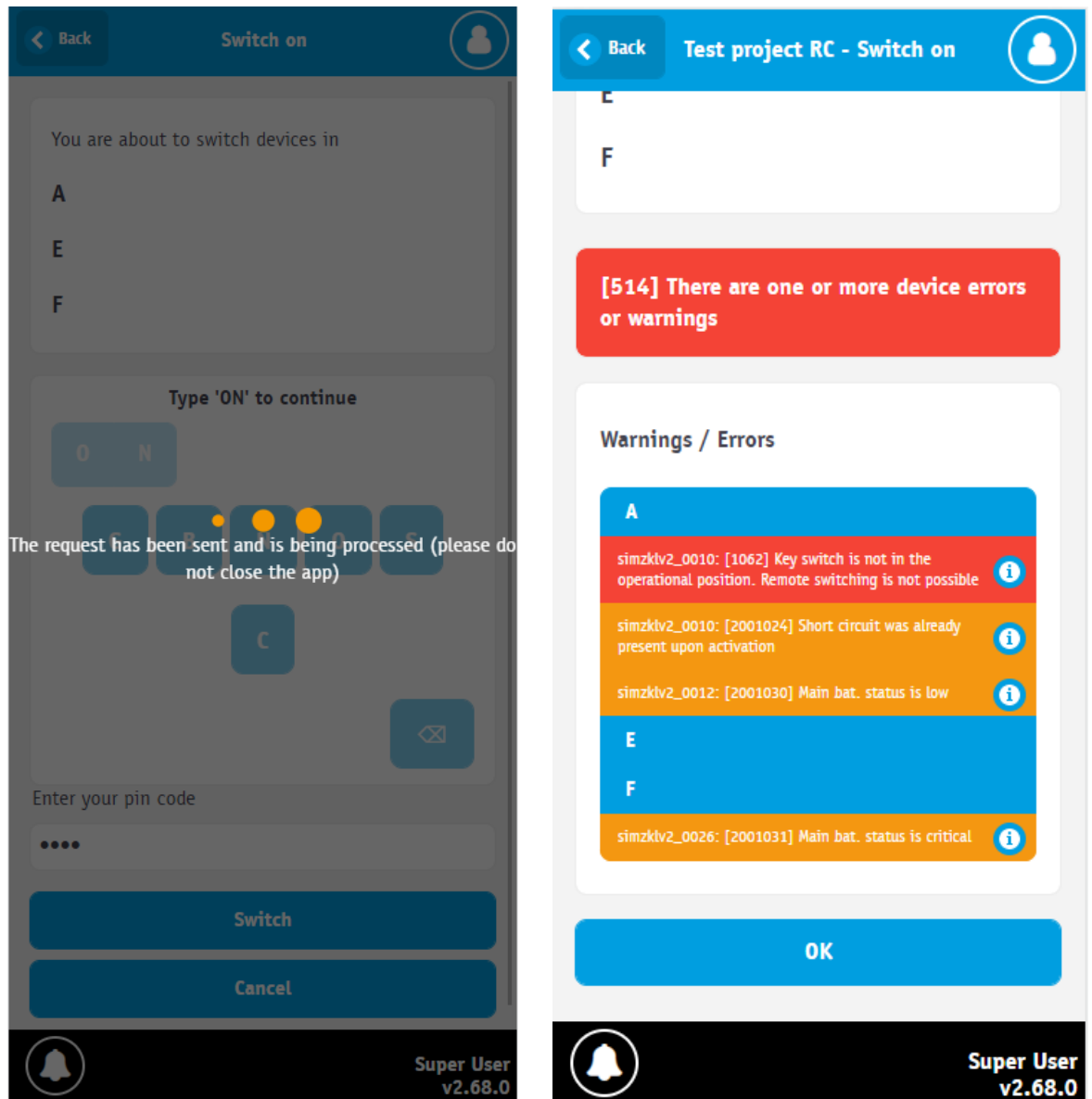

- Errors and warnings are grouped per protection zone and then per device
- Follow the instruction provided in the error/warning to resolve the issue, if this does not solve the problem contact Dual Inventive Support.

6. Tap "OK" to return to the "Switch zone" page.

## 1.3 Web application – Single zone switching

1. On the start page, click the 'Projects' tile or select 'Projects' in the 'Work management' menu at left of the screen. Search for the project for which you want to switch a protection zone and click the project to view it.

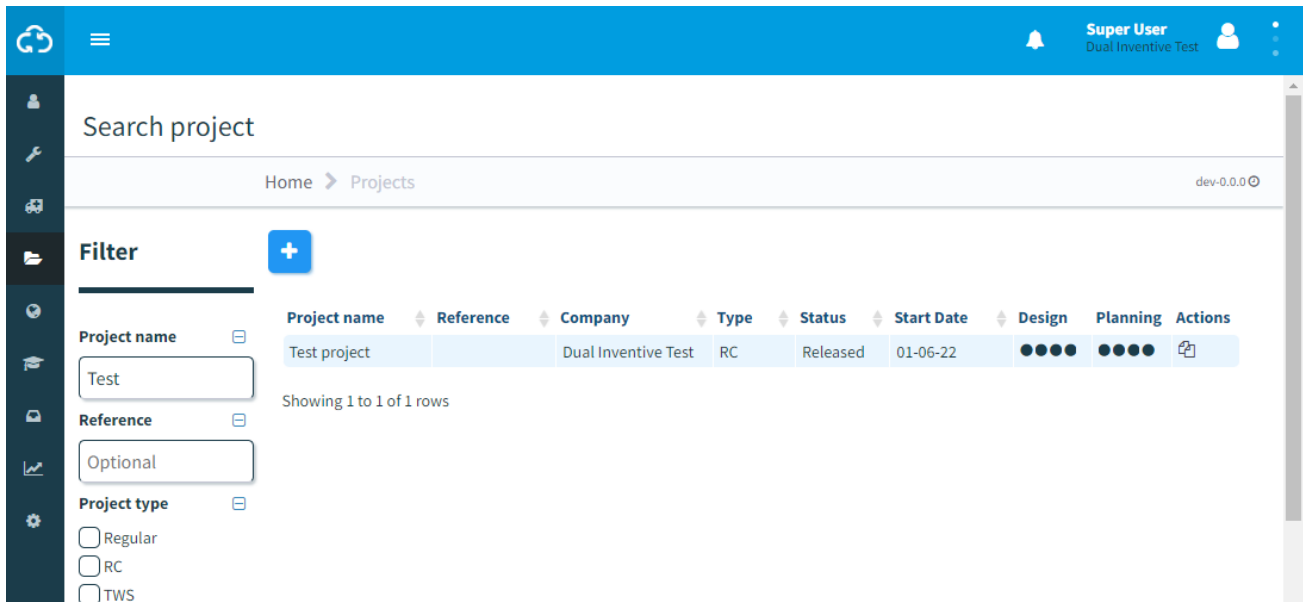
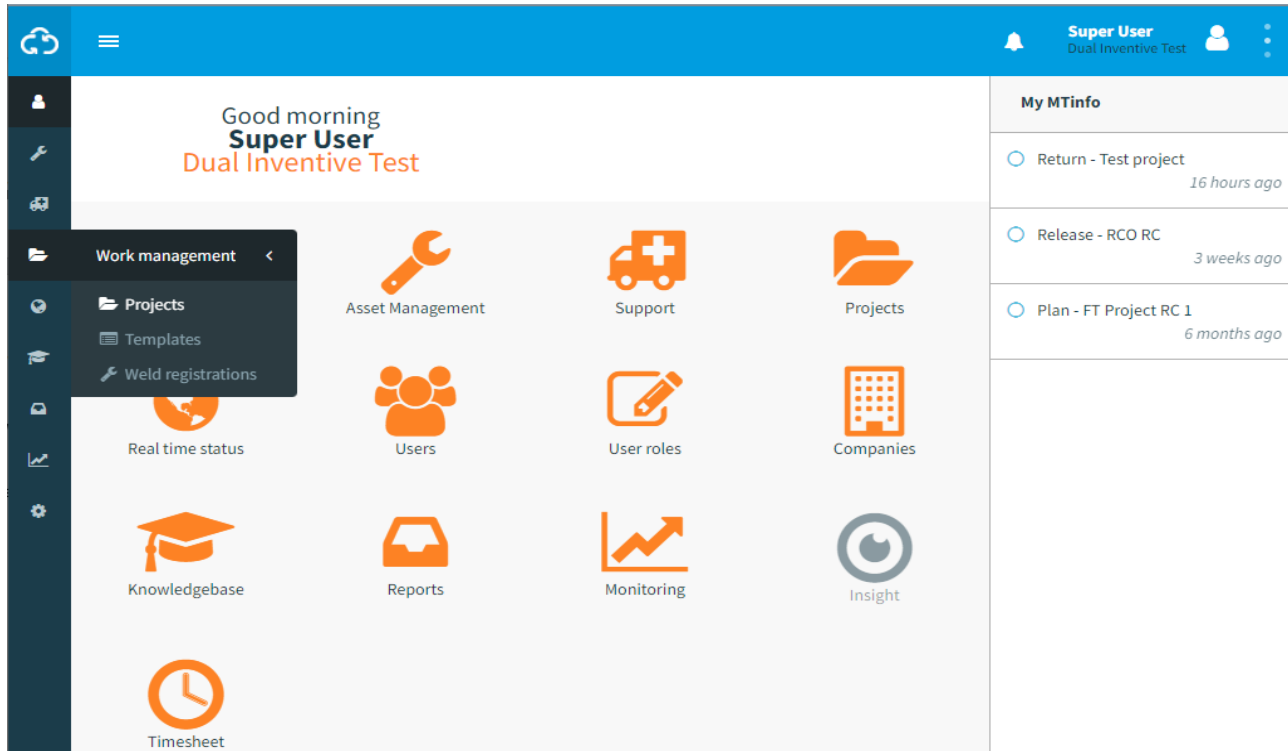





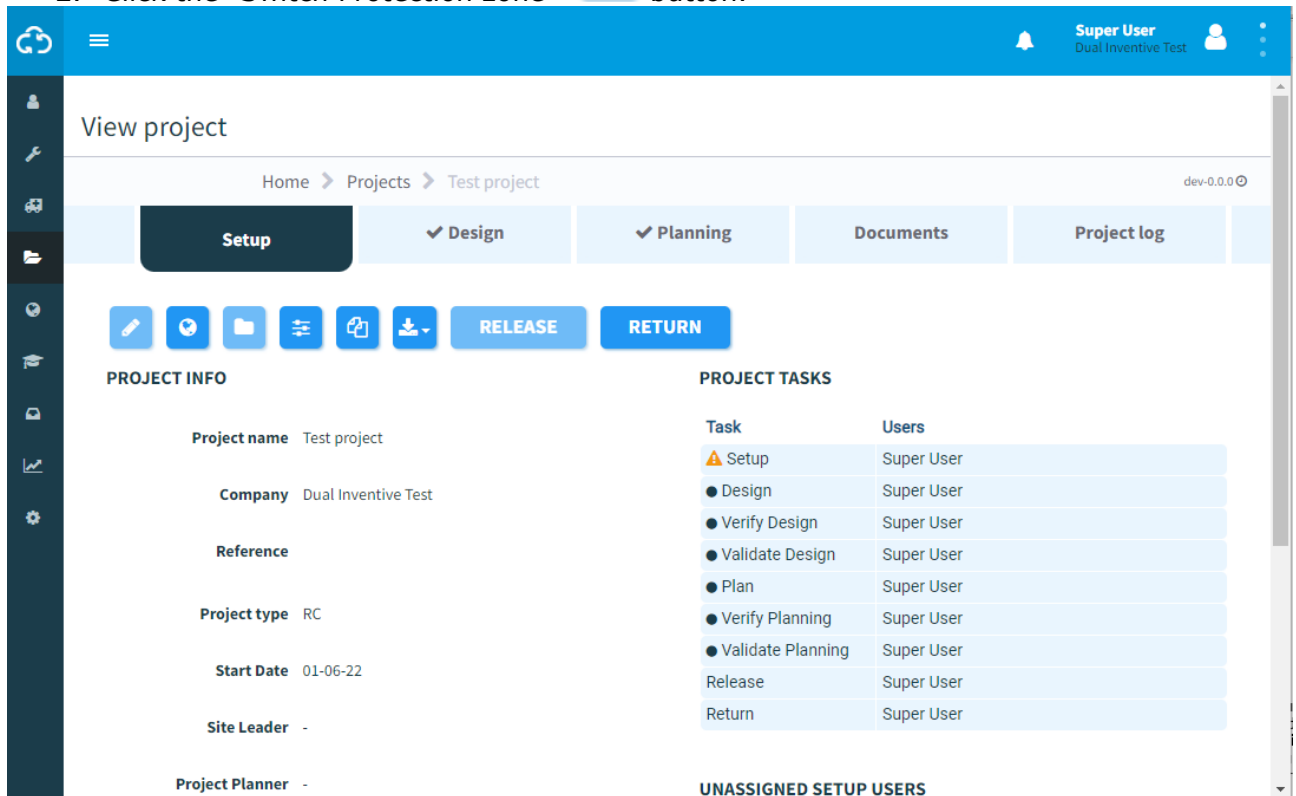



2. Click the "Switch Protection zone"  button.



View project

Home > Projects > Test project dev-0.0.0

**Setup** Design Planning Documents Project log

      **RELEASE** **RETURN**

**PROJECT INFO**

**Project name** Test project

**Company** Dual Inventive Test

**Reference**

**Project type** RC

**Start Date** 01-06-22

**Site Leader** -

**Project Planner** -

**PROJECT TASKS**



Task	Users
Setup	Super User
Design	Super User
Verify Design	Super User
Validate Design	Super User
Plan	Super User
Verify Planning	Super User
Validate Planning	Super User
Release	Super User
Return	Super User

**UNASSIGNED SETUP USERS**

- a. You can only switch protection zones for a released project. If the project is not released the button will be disabled.

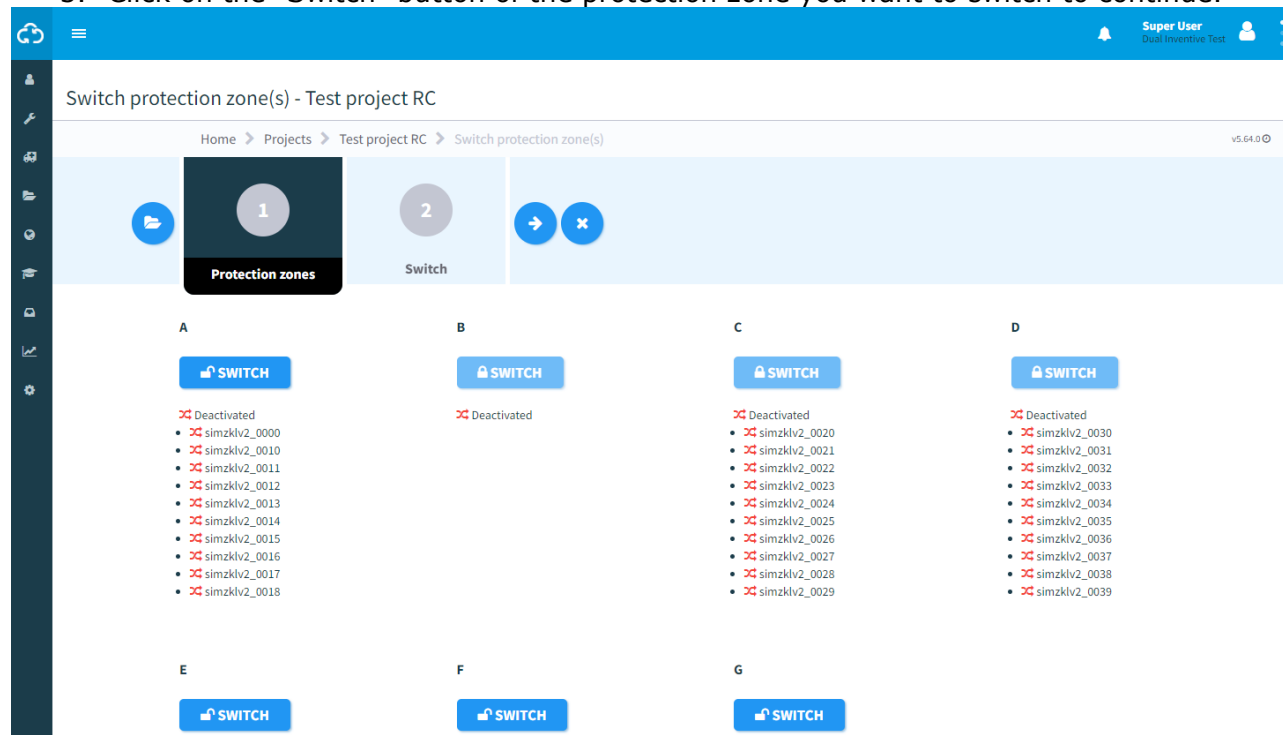
3. Click on the “Switch” button of the protection zone you want to switch to continue.



- If you are not an operator assigned to the protection zone or if you are not allowed to switch it at this time, it will be disabled. The “Switch” button will contain a closed lock icon and hovering over the button will show a tooltip why it is disabled.
- Click “Show devices” to see which devices are contained in the protection zone.
- The status of the zone will be indicated by an icon .
  - A light grey color indicates the status is unknown.
  - A green color indicates all devices within the zone have been activated and have no errors.
  - Red in all other cases.
- The status of each device will be indicated by an icon .
  - A light grey color indicates the status is unknown.
  - Green indicates the device is activated and no problems are reported.
  - Red in all other cases.
- Data is NOT updated in real time. It shows the last known status when the page opened.

5. Click "on" or "off" to respectively switch the devices in the protection zone on or off. Confirm the action by typing "on" or "off", enter your pin code and click "Switch" to continue or "Cancel" to abort.

- a. The status of each device in the protection is indicated by an icon  :
  - i. Light grey indicates the status is unknown
  - ii. Green indicates the device is activated and no problems are reported.
  - iii. Red in all other cases.
- b. Device data is updated in real time.

6. The result of the action is shown.

When the request is successful the result will be similar to the example below:

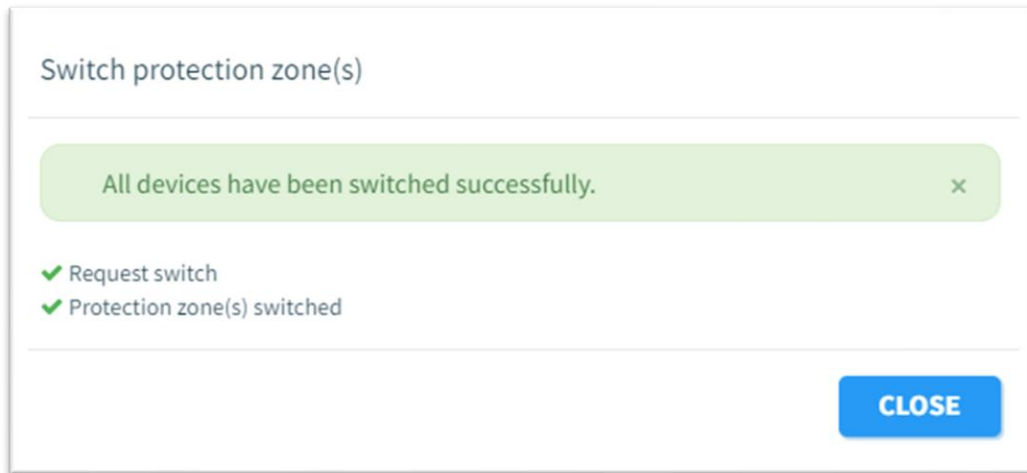

In case there are errors and/or warnings, the result will be similar to the example below:

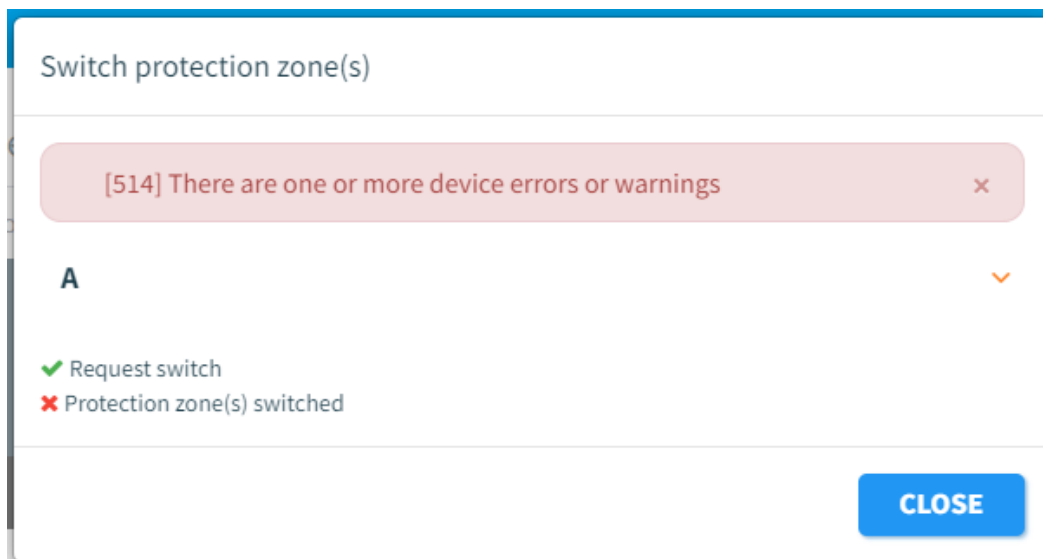

- a. A result message is shown:
  - i. A green color indicates everything went well
  - ii. A yellow color indicates switching succeeded, but one or more devices reported a warning.
  - iii. A red color indicates one or more devices did not switch successfully and reported an error.

7. In case of errors/warnings: click the name of the protection zone to show the error / warning details.

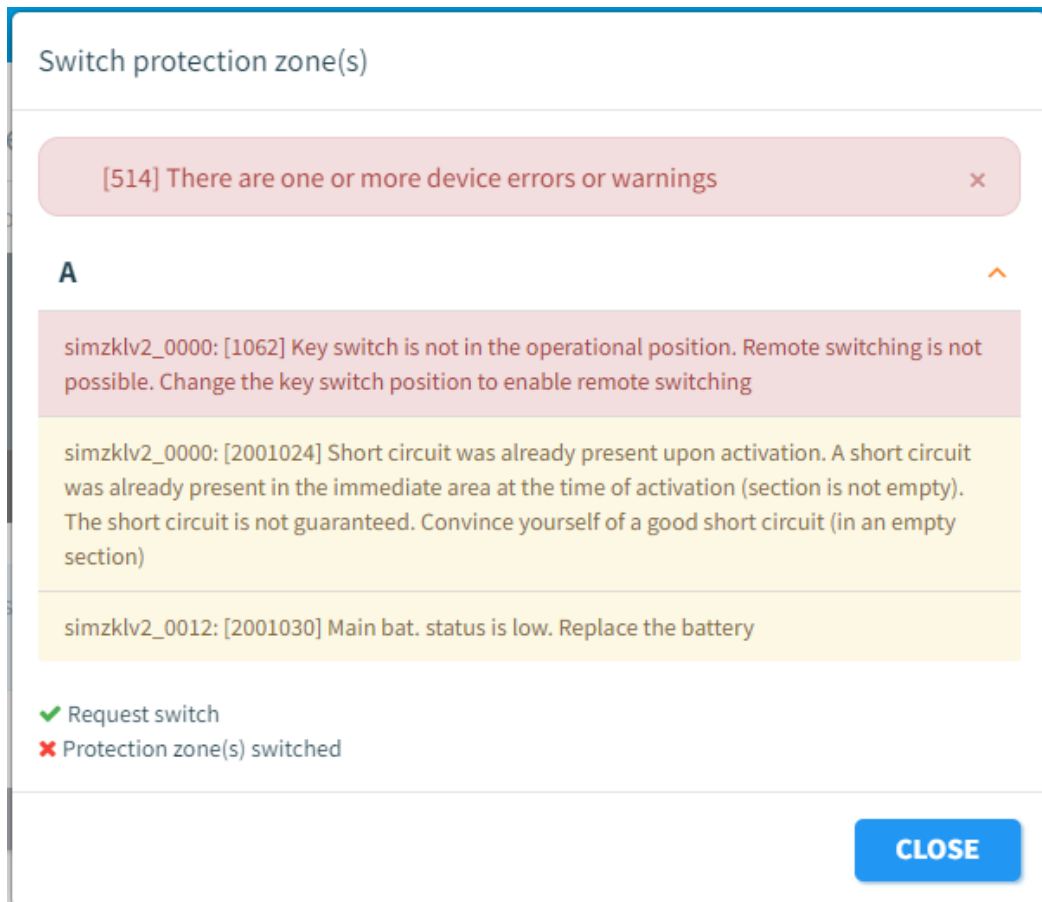

- a. Errors and warnings are grouped per device.
- b. Follow the instruction provided in the error/warning to resolve the issue, if this does not solve the problem contact Dual Inventive Support.

## 1.4 Web application – Multiple zone switching



### NOTE

It is only possible to switch multiple zones at once if this setting is enabled for your company.

1. On the start page, click the 'Projects' tile or select 'Projects' in the 'Work management' menu at left of the screen. Search for the project for which you want to switch a protection zone and click the project to view it.

Good morning  
**Super User**  
Dual Inventive Test

**My MTInfo**

- Return - Test project  
16 hours ago
- Release - RCO RC  
3 weeks ago
- Plan - FT Project RC 1  
6 months ago

**Work management**

- Projects
- Templates
- Weld registrations

Asset Management Support Projects

Real time status Users User roles Companies

Knowledgebase Reports Monitoring Insight

Timesheet

Search project

Home > Projects

dev-0.0.0

**Filter**

Project name: Test

Reference: Optional

Project type: Regular, RC, TWS

Project name	Reference	Company	Type	Status	Start Date	Design	Planning	Actions
Test project		Dual Inventive Test	RC	Released	01-06-22	●●●●	●●●●	

Showing 1 to 1 of 1 rows

2. Click the "Switch Protection zone"  button.

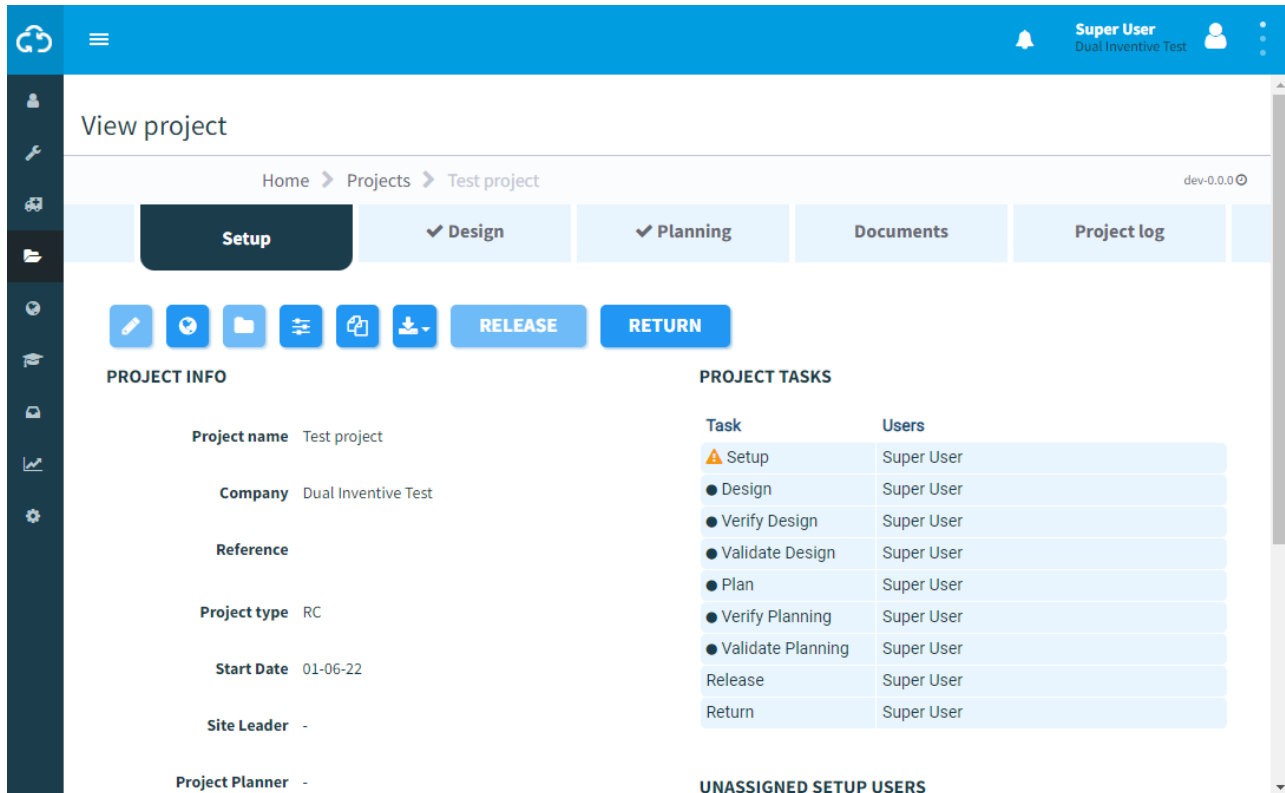

The screenshot shows the 'View project' page for 'Test project'. The page has a blue header with a cloud icon, a menu icon, and a user profile 'Super User Dual Inventive Test'. The breadcrumb trail is 'Home > Projects > Test project'. The version is 'dev-0.0.0'. The main navigation tabs are 'Setup', 'Design', 'Planning', 'Documents', and 'Project log'. Below these are buttons for 'RELEASE' and 'RETURN'. The 'PROJECT INFO' section shows: Project name: Test project, Company: Dual Inventive Test, Reference: (empty), Project type: RC, Start Date: 01-06-22, Site Leader: -, and Project Planner: -. The 'PROJECT TASKS' section shows a table with tasks and users.



Task	Users
Setup	Super User
Design	Super User
Verify Design	Super User
Validate Design	Super User
Plan	Super User
Verify Planning	Super User
Validate Planning	Super User
Release	Super User
Return	Super User

The 'UNASSIGNED SETUP USERS' section is empty.

- a. You can only switch protection zones for a released project. If the project is not released the button will be disabled.

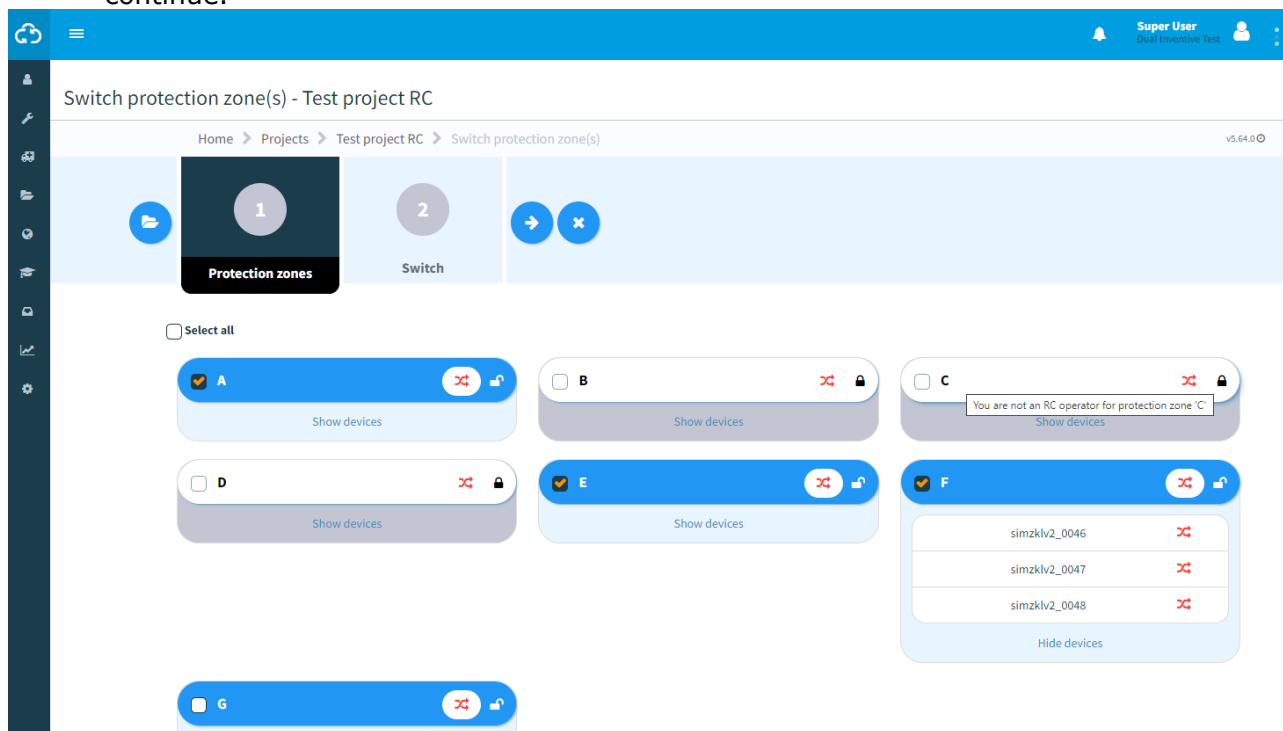
3. Check the zone(s) you want to switch by clicking it and then click on “Switch” to continue.



- a. If a protection zone is disabled, the header will contain a closed lock icon and hovering over the header will show a tooltip why it is disabled.
- b. The protection zone will be disabled if:
  - i. you are not an operator assigned to the protection zone
  - ii. you are not allowed to switch it at this time
  - iii. there are no devices assigned to the protection zone.
- c. Multiple zones can be selected.
- d. Click “Show devices” to see which devices are contained in the protection zone.
- e. The status of the protection zone will be indicated by an icon .
  - i. A light grey color indicates the status is unknown.
  - ii. A green color indicates all devices within the zone have been activated and no errors are reported.
  - iii. Red in all other cases.
- f. The status of each device will be indicated by an icon .
  - i. A light grey color indicates the status is unknown.
  - ii. Green indicates the device is activated and no problems are reported.
  - iii. Red in all other cases.
- g. Data is NOT updated in real time. It shows the last known status when the page opened.



5. Click "on" or "off" to respectively switch the devices in the protection zone on or off. Confirm the action by typing "on" or "off", enter your pin code and click "Submit" to continue or "Cancel" to abort.

- a. The status of each device in the protection zone is indicated by an icon  :
  - i. Light grey indicates the status is unknown
  - ii. Green indicates the device is activated and no problems are reported.
  - iii. Red in all other cases.
- b. The first protection zone is expanded, the other zones can be opened to show the devices contained within.
- c. Device data is updated in real time.

6. The result of the action is shown.

When the request is successful the result will be similar to the example below:

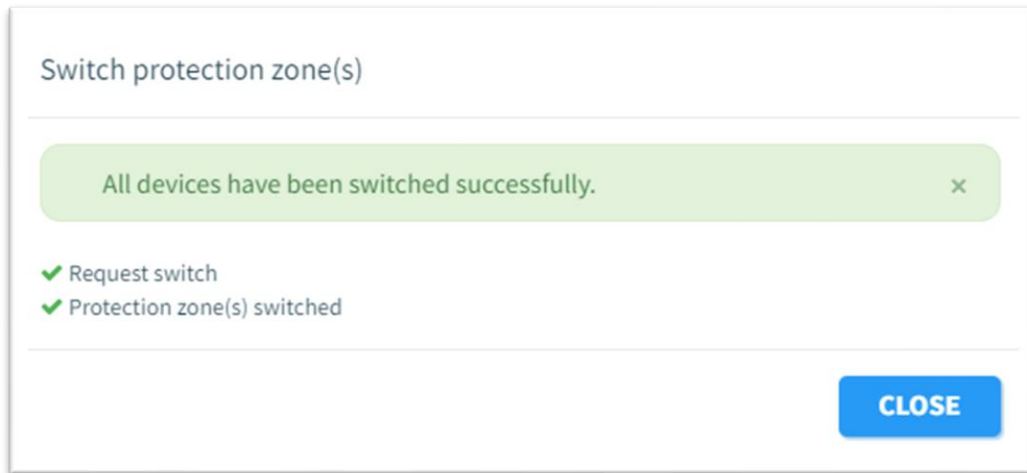

In case there are errors and/or warnings, the result will be similar to the example below:

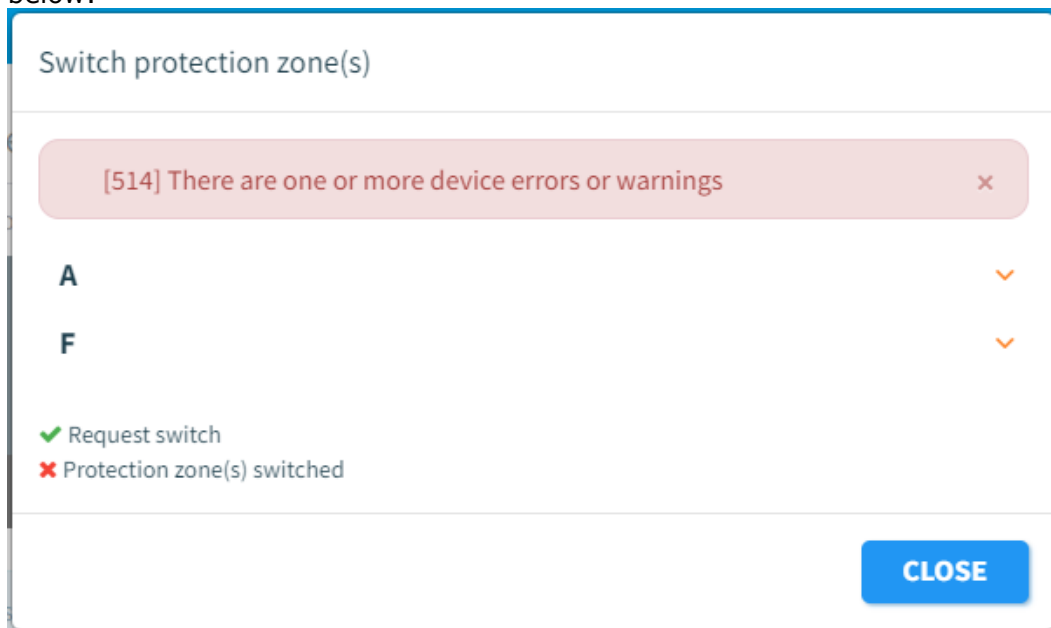

A result message is shown:

- i. A green color indicates everything went well
- ii. A yellow color indicates switching succeeded, but one or more devices reported a warning.
- iii. A red color indicates one or more devices did not switch successfully and reported an error.

7. In case of errors / warnings: click the name of the protection zone to show the error / warning details.

Switch protection zone(s)

[514] There are one or more device errors or warnings

A

simzklv2\_0000: [1062] Key switch is not in the operational position. Remote switching is not possible. Change the key switch position to enable remote switching

simzklv2\_0000: [2001024] Short circuit was already present upon activation. A short circuit was already present in the immediate area at the time of activation (section is not empty). The short circuit is not guaranteed. Convince yourself of a good short circuit (in an empty section)

simzklv2\_0012: [2001030] Main bat. status is low. Replace the battery

F

Request switch

Protection zone(s) switched

CLOSE

Switch protection zone(s)

[514] There are one or more device errors or warnings

A

F

simzklv2\_0026: [2001031] Main bat. status is critical. Replace the battery

Request switch

Protection zone(s) switched

CLOSE

- Errors and warnings are grouped per zone and then per device.
- Click the zone to show the errors / warnings for that zone.
- Follow the instruction provided in the error/warning to resolve the issue, if this does not solve the problem contact Dual Inventive Support.